

PARK UP

THE **WORLD'S MOST COMPACT**
AND POWERFUL **ROTARY ROBOTIC PARKING**,
BLENDING **URBAN AESTHETICS** WITH
GERMAN-KOREAN ENGINEERING,
ALL IN THE **SPACE OF TWO CARS.**



SPACE MAXIMIZATION

PARK UP's vertical structures increase parking spots up to 8 times, all within the world's smallest footprint. Give us a space just enough for two cars, and watch us work wonders.

ENDLESS EXPANSION

PARK UP's units can line up, creating a hub of hundreds of spaces in limited areas, turning tight urban spaces into expansive parking hubs.

MEET THE STRENGTH

PARK UP safely houses every vehicle, from family cars to hefty 3000kg SUVs. That makes us the most compact rotary robotic parking in the world.

RAPID INSTALLATION

PARK UP structures are installed in just 5 days, underlining the impressive speed of installation. Our quick setup is proof of our superior time efficiency.

GERMAN-KOREAN ENGINEERING

Built with a blend of German and Korean engineering, PARK UP combines longevity and advanced technology, backed by 2 decades of field experience.

PROFITABLE DESIGN

Our facades are more than just functional; they are profitable and combine aesthetics with lucrative advertising opportunities.

MORE PARKING, LESS EXPENSE

PARK UP is revolutionizing cost-efficiency. Our rotary robotic systems increase quickly, saving you time and money without extensive concrete work.



MOBILITY MASTERED

PARK UP's relocatable genius prioritizes flexibility. Our units can be easily relocated and reinstalled, making them the very definition of an adaptable urban parking solution.

ECO-EFFICIENT OPERATIONS

PARK UP leads the way in eco-conscious parking by reducing the hunt for parking spots, thereby considerably reducing carbon emissions.

TIME-SAVING TITAN

PARK UP saves time by reducing parking search time and improves productivity for businesses and individuals.

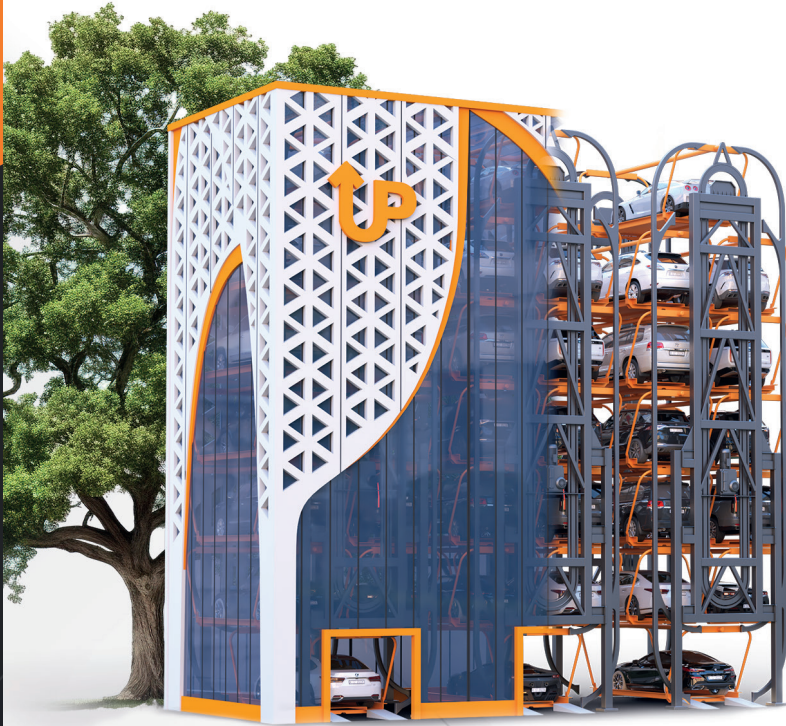

GREEN SPACE GUARDIAN

PARK UP transforms horizontal parking spaces into potential green oases. PARK UP's footprint opens doors for more open, green, and breathable urban areas.

VALUE-ADDING INFRASTRUCTURE

PARK UP increases the value of residential, retail, and commercial properties. PARK UP turns what was once a logistical challenge into a valuable asset by maximizing usable space and minimizing the area required for parking.

YOU CANNOT PARK CLOSER

ULTRA-QUIET OPERATION

PARK UP prioritizes quiet operation with a noise level of 75-65 dB, comparable to a normal conversation, minimizing disturbance for a peaceful urban experience.

ALL-WEATHER VEHICLE PROTECTION

PARK UP is a revolutionary concept that saves space and safeguards your vehicles from the perils of nature. Whatever the weather conditions, your vehicles are safe at PARK UP.

GRAVITY-POWERED EFFICIENCY

Using gravity to operate, PARK UP robotic parking systems consume %70 less energy than conventional lifts.

CUSTOMIZABLE LOTS

PARK UP units offer customizable designs from 8 to 16 cars in multiple. We customize parking solutions for every space requirement and precise parking needs.



PARK UP APP & SOFTWARE

PARK UP goes well beyond hardware. Manage your system with our easy-to-use app and software. Our in-house technical team is available for customization and continuous assistance.

LOCAL SUPPORT

PARK UP provides local technical support from our Dubai office. We are always ready to help you and make sure that your parking units will run smoothly and effectively.

EFFORTLESS MAINTENANCE

PARK UP Requires only simple, periodic upkeep, minimizing downtime and operational costs.

THE UNIVERSAL LANGUAGE OF EFFICIENT PARKING

Parking challenges don't have a passport. PARK UP speaks the universal language of efficiency, serving businesses like yours – from local government offices, automobile dealerships, developers, hospitals, concert areas, and stadiums to private residents.– worldwide. Let's transform your parking landscape as it should be...

LESS SPACE, MORE CITY

"Less space, more city" is our clear mission. PARK UP promises to create liveable, breathable urban environments by maximizing space efficiency and promoting green urban planning.



PARK UP | PU12SUX

PARK UP's advanced rotating robotic parking systems maximize space efficiency and revolutionize the parking space. PARK UP's latest PU12SUX model is designed to transform the limited parking spaces into a space-efficient masterpiece needed in today's urban environments.

The PU12SUX can increase parking capacity by up to 6 times for large SUVs without requiring additional horizontal space.

Designed for high vehicle turnover, PU12SUX is an optimal solution for areas with limited parking space. PU12SUX is a major game changer in dense urban environments where every square meter and every type of vehicle counts.

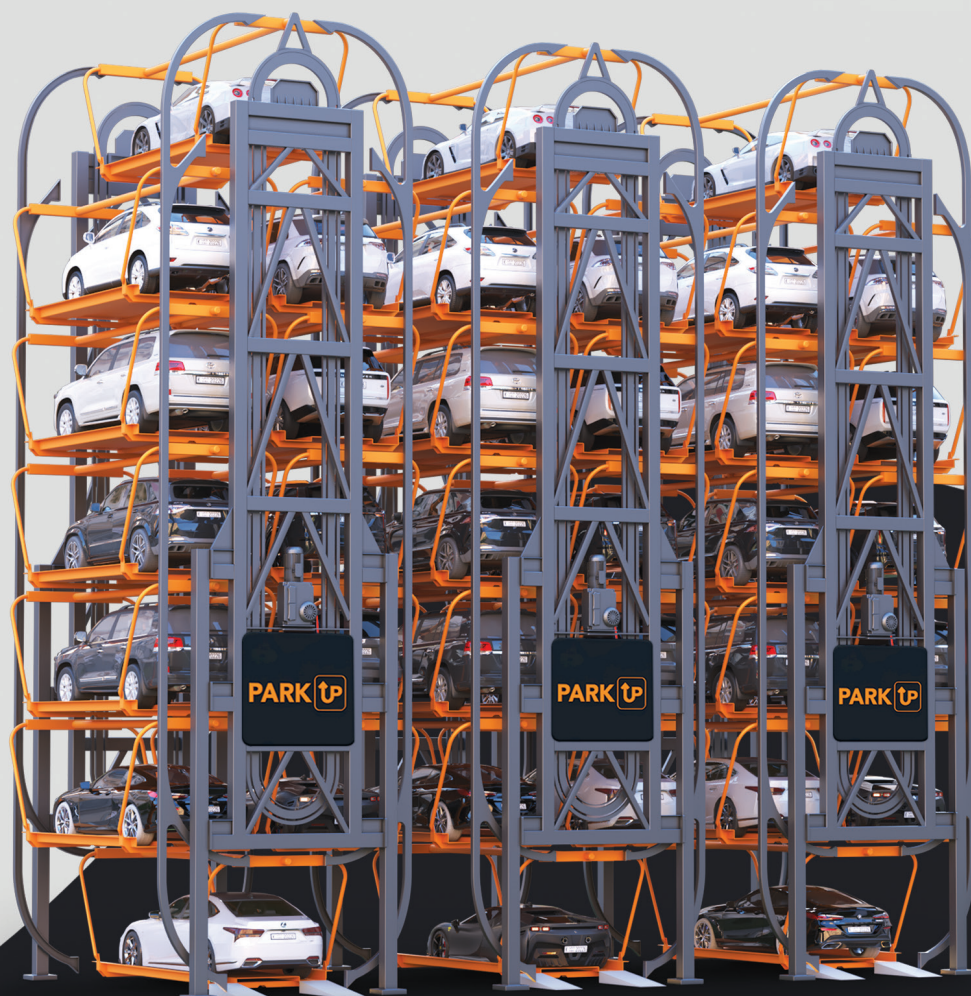



GENERAL SPECIFICATIONS

Overall Dimensions:

- Height: 17200 mm (excluding facade)
- Length: 17200 mm (front view)
- Width Between Columns (Centerline): 3300 mm
- Required Width: 6100 mm
- Required Depth: 7100 mm

CAPACITY

- **Parking Capacity:** Can accommodate 12 cars per unit in a circular layout, designed for quick access and retrieval.

STRUCTURAL DETAILS

- **Column Placement:** Features a central load-bearing column that optimizes stability and vertical space utilization.
- **Rotation Mechanism:** Incorporates a centralized motorized rotation platform for efficient vehicle placement and retrieval.

MECHANICAL SPECIFICATIONS

Motor:

- **Type:** 15 kW x 4P (German engineering)
- **Control:** Inverter Control
- **Power Supply:** AC415/400/380V x 3Ph x 60/50Hz

Performance:

- **Speed:** 5 m/min
- **Vehicle Weight Capacity:** Each parking spot supports up to 3000 kg.

VEHICLE COMPATIBILITY

Applicable Vehicle Types: The system suits various vehicle sizes, including SUVs and sedans.

Compatible Vehicles:

- Toyota Land Cruiser
- Ford Expedition
- Cadillac Escalade

SAFETY AND INTERFACE

- **Safety Features:** Equipped with multiple safety sensors and emergency stop mechanisms to protect users and vehicles.
- **User Interface:** Features an advanced user interface for smooth operations, with potential for smart city infrastructure integration.

CONTROL AND COMPATIBILITY

- **Control System:** Each unit is equipped with an inverter control and a standard keypad control panel for precise parking operation.
- **PLC Compatibility:** The PLC technology is fully compatible with all required software systems for reliable and efficient operation.
- **Customization Options:** Customization of control interfaces is possible to meet specific operational needs.

DESIGN AND AESTHETICS

- **Visual Profile:** Adaptable to urban environments' aesthetic and functional requirements, the system is sleek and functional. Facades can be customized to match local architectural styles.

MATERIALS AND ORIGIN

- **Body Construction:** Korean-licensed steel structure.
- **Drive and Motor:** Powered by German SEW Eurodrive motors or their equivalent.
- **PLC:** Integrated with PLCs from Korean LS Company.

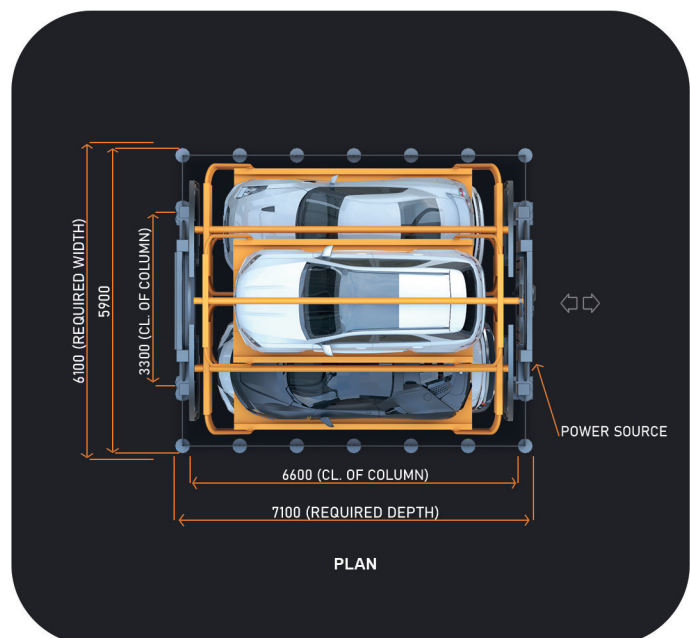
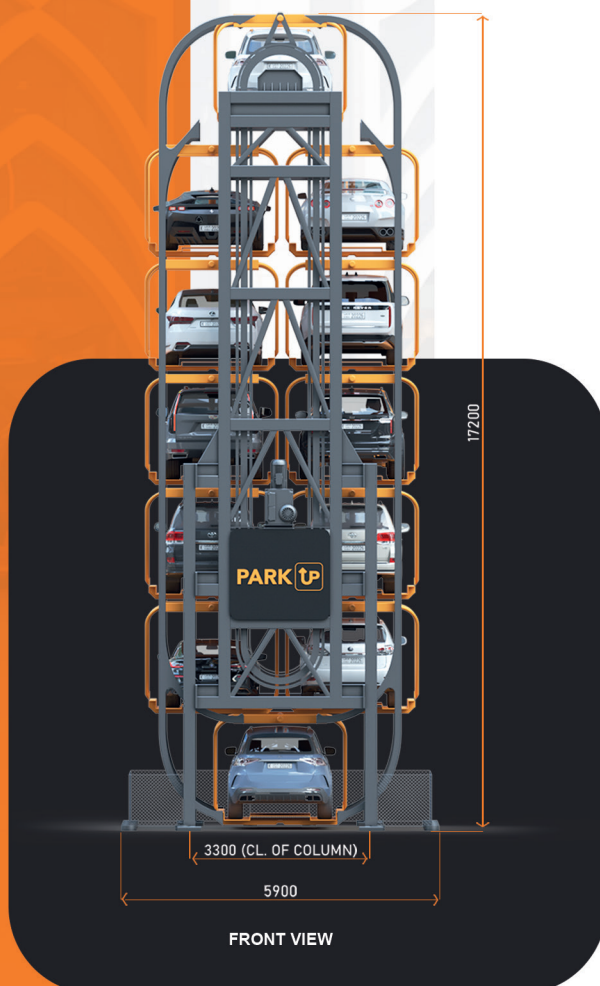

CRAFTING A MORE LIVEABLE, BREATHABLE CITYSCAPE.

care@parkup.ae • www.parkup.ae

PARK 

